

Opéra Conique

abrem as grades lateralmente em 4 partes.

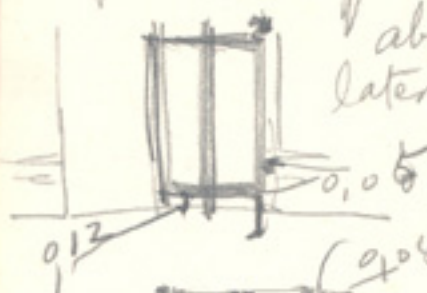

fechadas com cremosine

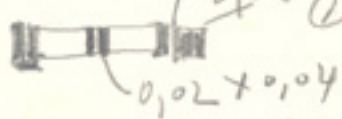

nota curvada cada abrimto e a fora 0,15



na frente



Trunk
S. Anastasia

S. Marcellus
font de l'abside



1891/1892/0625-003V

capitel do arco duplo do fundo

Vesperas

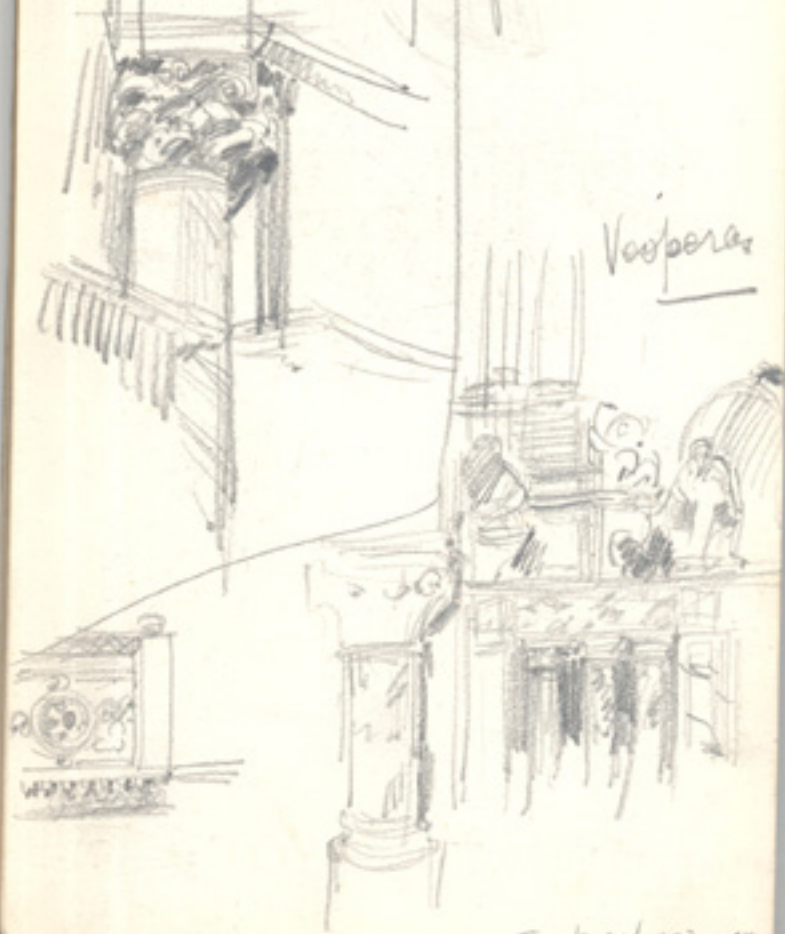

Bivala aqua —

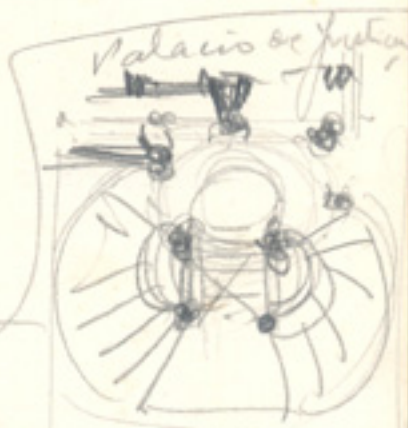
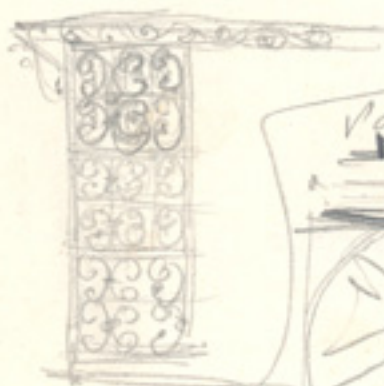

Palazzo Vecchio

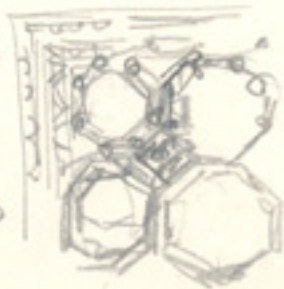
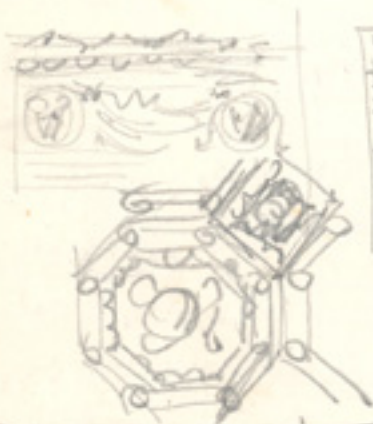

et segun solo los pentagones

of plantago test

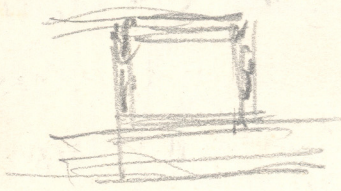
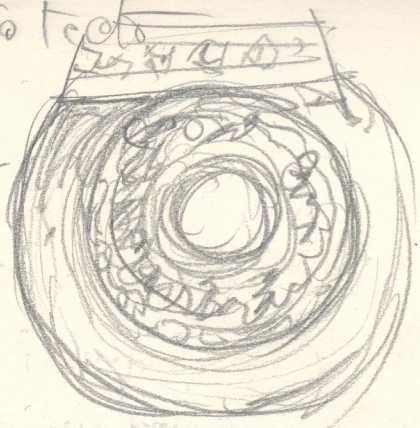
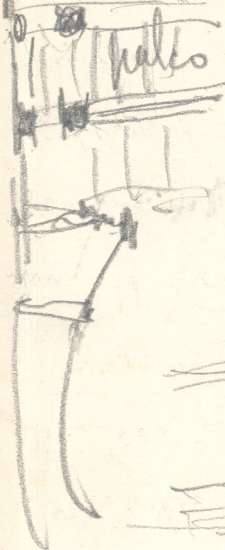



4 ems
loges
corredores
Garranca de
ladrilhos de
gres escura

4 ems loges ladr
5 de gran



varmelhas
Vish. ros
porta do

Amphite Camaroto

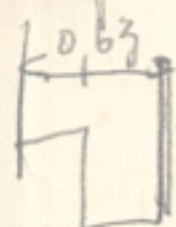

grades



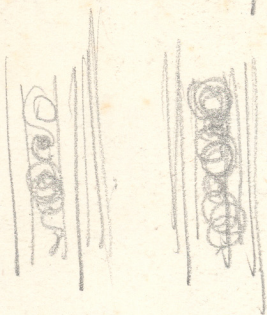
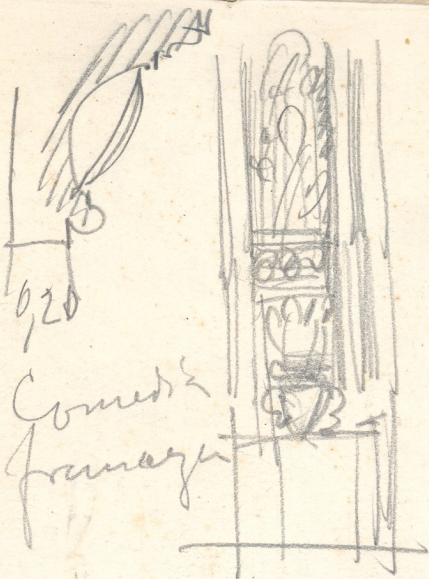

base
opera
Comique

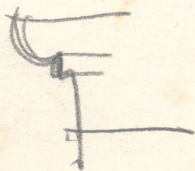

Capiteis bronze
e cornija
mar moses
Hermelles

Comedia franceza
un chariot 2,1,60 de lar-
gura
Chariot de la Comedie

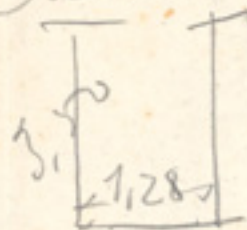

longueur 6,00

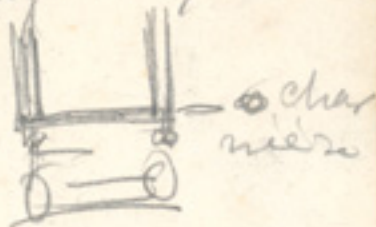

Carrosse de

fora
entre dents

100
Drawing
in pencil

Sarah Bernard

